



**Location: Unit #7, Lot 10 Twickenham Park,  
St. Catherine, Jamaica.**

**Contact Numbers:**

**Office: 1-876-648-7371**

**Cell: 1-876-494-1224**

**Email: [info@elevateja.com](mailto:info@elevateja.com)**

**Website: [www.elevatebusinessservices.com](http://www.elevatebusinessservices.com)**



**@elevatebusinessservices**

## 1. About Us:

Welcome to a world where quality meets creativity. At Elevate Business Services Limited, we pride ourselves on our ability to fuse High Quality Moisture Resistant Boards (Particle Board (PB) and Medium Density Fiber (MDF) materials with bespoke designs, bringing your kitchen, bathroom, closet, entertainment stands and other furniture to fruition.

Unleash the potential of your space with our dedication to quality and expertise within the woodworking industry. With our Semi-Automated factory, we have capabilities to meet high demand (multi-unit homes) with fast turnaround times and quality to boards into timeless pieces that elevate your space.

Your satisfaction is our ultimate goal as such our full product portfolio which includes but not limited to Countertops, Sinks, Faucets, Accessories etc will ensure you are satisfied.

We are one of Jamaica's leading businesses specializing in the manufacturing and distribution of Fast Moving Commercial Goods (FMCG) serving the Construction Industry. Our comprehensive range of services includes logistics and supply chain, construction and building maintenance, state-of-the-art manufacturing and automation services, and expert Project Management for both commercial and residential construction projects.

2. Table of Content:

Contents

3. Wall Cabinets .....10

## 3. Types of Construction Method:

### Construction Method

#### Wall Cabinet:

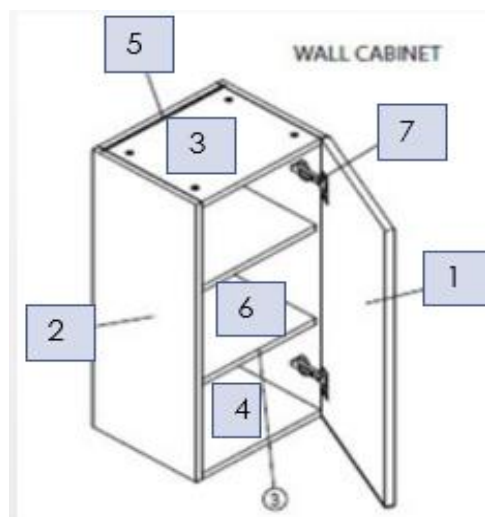

	Parts	Elevate Essential	Elevate Premium	Elevate Plus (+)
<b>Wall Cabinet</b>				
1	Door	18mm Both Side Laminated (BSL) Particle Board (PBD) or Medium Density Fiber Board (MDF)	18mm BSL/ PBD/MDF	<b>18mm PBD / MDF</b>
2	Side Panels	15mm BSL PBD / MDF	18mm BSL PBD/MDF	
3	Top Panel	15mm BSL PBD / MDF	18mm BSL PBD/MDF	
4	Bottom Panel	15mm BSL PBD / MDF	18mm BSL PBD/MDF	
5	Back Panel	<b>None</b>	<b>8mm White MDF</b>	
6	Shelves	<b>15mm BSL White PBD</b>	18mm BSL PBD/MSF	
7	Hinge	Adjustable Soft close	Adjustable Soft close	
8	Assembled with Screws, Glue / Dowels			

## Base Cabinet:

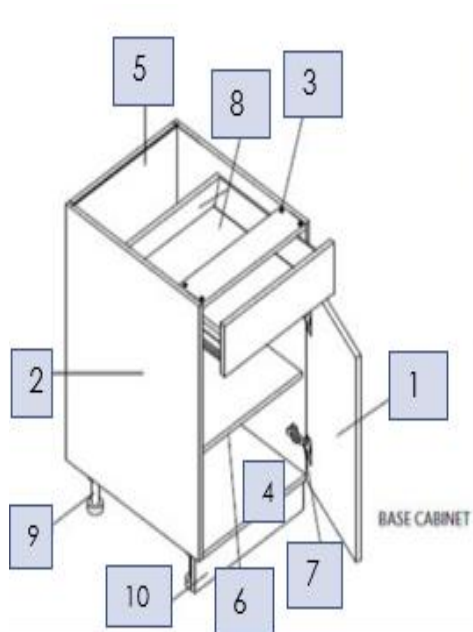

Base Cabinet				
1	Door	18mm BSL PBD/MDF	18mm BSL PBD	<p>You can add any accessory to your design of choice, such as:</p> <div><div>1. Spice Rack,</div><div>2. Trash Pull out</div><div>3. Lazy Susan Kidney</div></div> <p>*More options will be added shortly.</p>
2	Side Panels	15mm BSL PBD/MDF	18mm BSL PBD	
3	Top Panel	18mm 3” Strip PBD/MDF (Open)	18mm 3” Strip PBD (Open)	
4	Bottom Panel	15mm BSL White PBD/MDF	18mm BSL PBD	
5	Back Panel	15mm 3” Strip PBD/MDF (Open)	18mm 3” Strip PBD (Open)	
6	Shelves	15mm BSL White PBD/MDF	18mm Design	
7	Hinge	Adjustable Soft Close	Adjustable Soft Close	
8	Drawer	PBD Soft Close	Draw System (Metal Sides) Soft Close	
9	Legs	4” Adjustable Plastic	4” Adjustable Plastic	
10	Toe Kick	18mm PBD/MDF	18mm PBD/MDF	
11	Assembled with Screws, Glue and Dowels			

## 4. How to place an Order:

### 1. How to Measure your Kitchen:

#### HOW TO MEASURE YOUR KITCHEN

##### STEP 1

Make a rough sketch of your room, large enough to fit all the measurements and notes.

For door ways, draw the door way according to which way the door swings.



##### STEP 2

Sketch any obstructions, for instance; pipes, sink, plumbing, columns etc that you either cannot move or do not want to move.

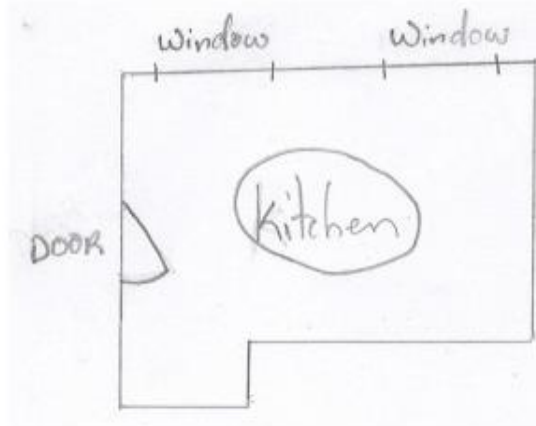

##### STEP 3

Start in one corner and measure around the room along each until every wall, window & door has been measured..

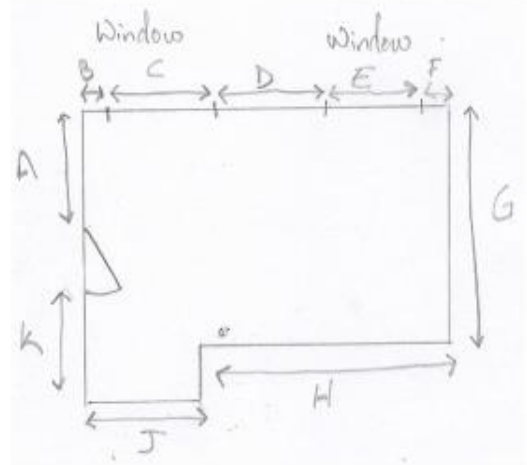

##### STEP 4

Draw the location of all appliances and write the sizes in inches.

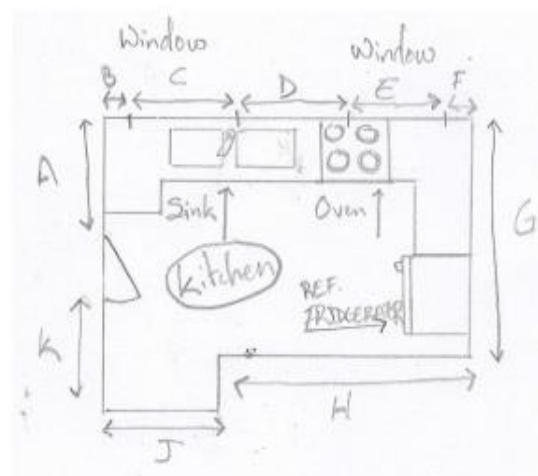



## 5. Colours and Boards Available:

### Opening Line

At Elevate Business Services we use the highest quality Laminated Particle Boards (PB) and Medium Density Fiber Boards (MDF) both being Moisture Resistant. We import our boards from various suppliers who meets the highest standards within the industry.

### **Particle Boards are:**

A manufactured wood/board made of very small pieces of wood bonded together with glue and other resins at high temperatures. It is a high density, strongly bonded, economical and general-purpose board made of large wood particles in the core and finer particles on sanded surfaces.

### **Medium Density Fiber Boards (MDF) are:**

Medium-density fibreboard (MDF) is an engineered wood product made by breaking down hardwood or softwood residuals into wood fibre, often in a defibrator, combining it with wax and a resin binder, and forming it into panels by applying high temperature and pressure.

Basic Composition of a PVC MDF Panel:

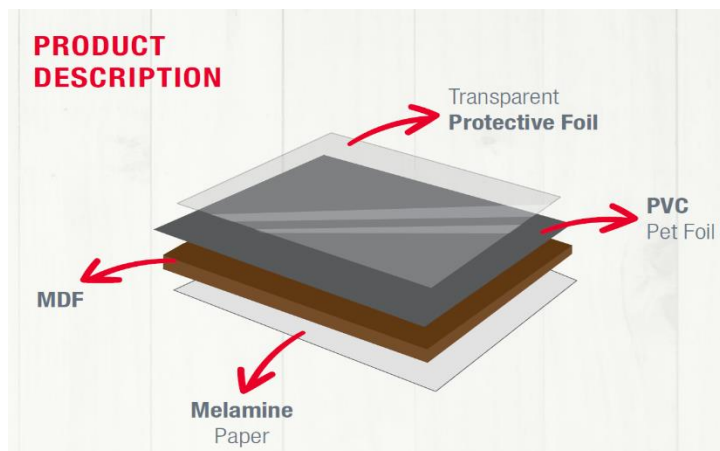

Type of Finishes we offer:

1.

## Ultra High Gloss

UHG is made by laminating a very durable decorative foil on a refined calibrated and one-sided melamine coated MDF. The printed film is ideally suited for lamination of MDF.

Thanks to the wide color range and exciting variety of decors and contrasts, UHG meets different design requirements in interior furniture .

The homogeneous MDF material as a carrier material contributes positively to the properties of the high gloss surface and is a cost-effective solution for your premium ideas. Without taking protective measures like painting or any time – consuming preparatory work, UHG boards are ready for use and easy to process: simply cut, edge and use.

2.

## Super Matte

Super Matte is the latest product release from Gizir, showing their end-less pursuit to offer products in line with newest trends in the market. It is processed using a state of the art PUR line in a clean room environment. It is laid up on a refined and calibrated MDF core to ensure a smooth surface.

The “soft touch” is silky smooth to the touch. It gives the material a warm and velvety feeling. The muted colors convey an unobtrusive and high-quality sense of space.

Super Matte by Gizir offers a very durable panel at one of the best price points in the matte finish arena.

3.

## Matte

Have you ever touched an oil canvas? Have you run your fingers up the tree, enjoying its shadow? What have you felt ? Let's relive this feelings with our matte MDF panels.

Matte panels are manufactured by application of matte foil to the refined and calibrated MDF.

The Smooth and textured surface design creates a warm, cozy ambience. In our color range, we strive to be as close to the natural look as possible. Matte colors are optically and haptically veneer like, in close association with stone or leather but with a price advantage.

Authenticity is our product's unique feature.

Applying these expressive and sensual surfaces will create impressive living spaces and furniture.

This product finds perfect fit in the kitchens, bathrooms, living rooms, bedrooms, hotel furniture.

The edge bands are perfectly matched in color and texture to the panel decors, as a finishing touch for the perfectly designed product.



## 5. Colours and Boards Available – MDF Boards:

### Ultra-High Gloss Panels:

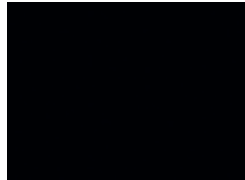

High Gloss White Acrylic – 18mm  
High Gloss Grey Acrylic – 18mm  
High Gloss Black Acrylic – 18mm

### Gloss Panels

Light Grey

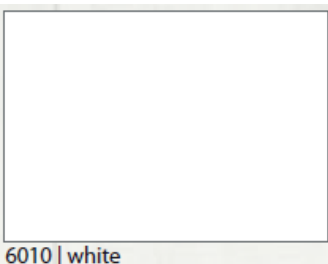

6010 | white



Solid White Matte PVC – 8mm  
Solid White Matte PVC – 16mm  
Solid White Matte PVC – 18mm

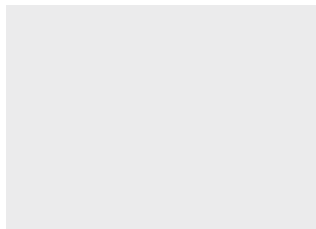

White Ultra PVC – 18mm  
Light Grey PVC – 18mm

### Super Matte Panels



S040 | sm black



S063 | sm green



S064 | sm blue

Techno Black – 18mm  
Techno Blue – 18mm  
Techno Green – 18mm

### Matte Panels

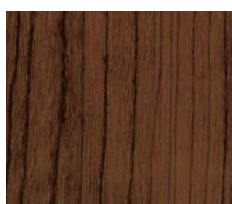
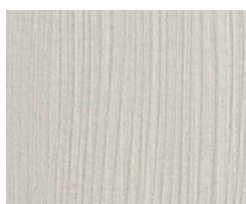

Antique Light Matte – 18mm  
Spruce White Matte – 18mm  
Tobacco Brown Matte – 18mm

## 6. Colours and Boards Available – Particle Boards:



Gris Gu III – 18mm, Finish: Soft/Matt

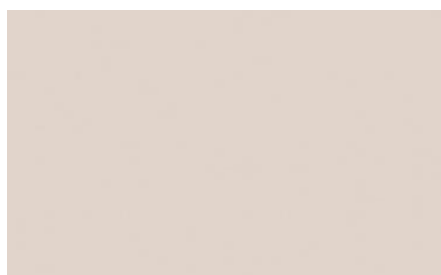

Coco – 18mm Finish: Soft/Matt



Azul Soft – 18mm, Finish: Soft/Matt



Robel Joplin – 18mm, Finish: Textured



Robel Hera – 18mm, Finish: Textured



Nogal – 18mm, Finish: Textured

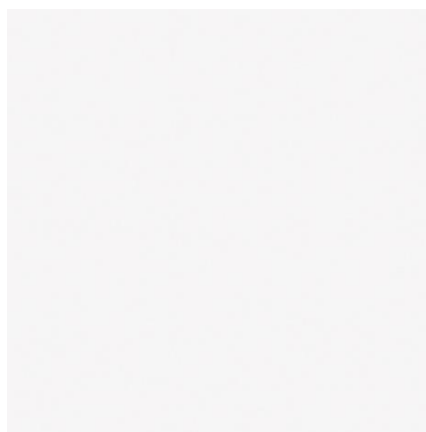

Blanco – 16mm, Finish: Matt

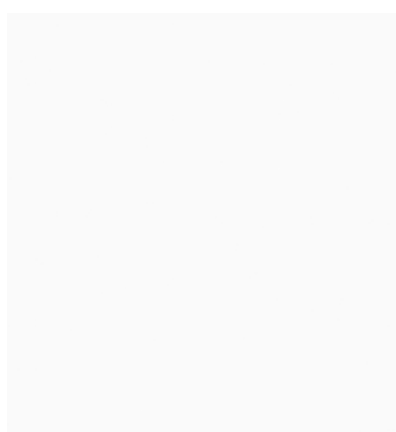

Brillo Blanco – 18mm, Finish: Gloss



Olmo – 18mm, Finish: Textured

\*[www.finsa.com](http://www.finsa.com)

## 6. Wall Cabinets:



## 7. Base Cabinets:



## 8. Base Cabinets:





## 9. Pantry and Tall Storage Units:



## 9. Vanity:

- Design and Style vary widely, contact us and we'll help you to complete your preferred design.

## 10. Closet:

- Design and Style vary widely, contact us and we'll help you to complete your preferred design.

## 11. *Entertainment Stand:*

- Design and Style vary widely, contact us and we'll help you to complete your preferred design.

## 10. *Handles: - Add code to make easier to find*

### 96 mm Center-to-Center Round Naples Bar Pull – (4")

Part #: 176-Pull  
Q4 96 SN

(Default Handle Quoted for Cabinets and Drawer Systems)



### 192 mm Center-to-Center Round Bar Pull – (8")

Part #: Q4 192 SN

(Default Handle Quoted for Pantry Doors)



### 96 mm Center-to-Center Round Bar Pull – (4")

Part #: Q4 96 MB



### 192 mm Center-to-Center Round Bar Pull – (8")

Part #: 272 MB





## 128 mm Center-to-Center Round Bar Pull – (5")

Part #: Q4 128SN



Part #: Q4 128 MB



## 96 mm Center-to-Center Square Dominique Bar Pull – (4")

845-Pull  
Out of Stock



## 160 mm Center-to-Center Square Bar Pull – (6")

Out of Stock



## 96 mm Center-to-Center Squared Stanton Bar Pull – (4")

Part #: 625-Pull  
Q2 96



Part #: Q2 96 MB



## 160 mm Center-to-Center Squared Bar Pull – (6")

Part #: Q2 160



Part #: Q2 160 MB



## 224 mm Center-to-Center Stanton Pull Finish – (9")

Part #: 625-224



## 60 & 90mm Center-to-Center Edgefield Tab Pull – (2" & 4" )

Part #: A500-3



Part #: A500-8



## Torino Cabinet Wire Pull – (4")

Part #: S271- 4SN



## 160 mm Center-to-Center Sullivan Pull Finish – (6")

Part #: 752-160BNBDL



## 128 mm Center-to-Center Dominique Pull Finish – (5")

Part #: 845-128BG



Part #: 635-Pull  
Q6 96

## Sutton Square Cabinet Bar Pull – (4")

Part #: Q6 96 MB



## Sutton Square Cabinet Bar Pull – (6")

Part #: Q6 160

Part #: Q6 160



## 11. Accessories/Pull-Outs:

### Spice Rack Pullout with Soft Close (DBPO-8SC)



#### Description

Maximize your cabinet storage with our Spice Rack pullout with reduced height designed to fit under a drawer in a standard height base cabinet with a 9" opening width. The pullouts feature premium Soft-close undermount slides top-mounting bracket with heavy-duty slide. Eliminates side-to-side movement and sag commonly seen in other pullouts.

#### Product Dimensions

W – 8.5"

H – 20"

D – 22"

Weight Capacity – 100lbs

# of Shelves – 3

Material – White Birch

Mounting: Both stand alone and Door Mountable.

### Trashcan Pullout Soft Close (CAN-EBMSPC-R)



#### Description

Save room on the kitchen floor by tucking away trash cans in a cabinet with our single can polished chrome wire trashcan pullout. Slides out on 100 lb. rated full-extension slides. Comes with a wire handle for hinged door applications. Works with either 50 qt can or 35 qt can. Trash can and lids are sold separately as well as an optional door-mounting kit. Pullout fits in a 12" cabinet opening.



**Door Mounting Kit (Can-Door KitPC)**



**Waste Basket 35 Quart (Can-35W)**

#### Product Dimensions

W – 10.5"

H – 13"

D – 22-1/16"

Weight Capacity – 50lbs

# of Shelves – N/A

Material – Heavy Gauge Wire

Mounting: Both stand alone and Door Mountable.

Other Accessory – Tash Can sold separately.

**Lazy Susan Kidney – 28" (w/two Shelves) (PLSMK28)**



**Description**

Optimize corner cabinets with a 28" kidney lazy Susan set. Sturdy polymer plastic trays with robust rib construction make for a secure shelf. Chrome metal hubs add a stylish accent. Telescoping pole locks in place at your desired height. Each shelf is independently rotating, and hubs have a positive stop, so cutout stops at the door opening. Each unit is tested to exceed BHMA Class-1 specifications of 20 pounds per square foot for 75,000 cycles. Set includes two shelves, chrome pole and hubs.

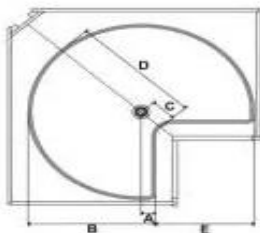

**Plastic Lazy Susans with Chrome Metal Hubs**

Shelf	Series	A	B	C	D	E
24" Kidney	PLSMK24	2-1/16"	14-1/16"	3-15/16"	15-15/16"	9-15/16"
28" Kidney	PLSMK28	2-1/16"	16-1/16"	3-13/32"	17-13/32"	11-15/16"
32" Kidney	PLSMK32	2-1/16"	18-1/16"	3-29/32"	19-29/32"	13-15/16"



## 12. Accessories:- Hinges and Draw Slides

### Hinges

**110 Heavy Duty Full Overlay Adjustable Soft Close Hinge with 8mm Press In Dowels. [1750.0181.25]**



**Standard Duty 8mm Cam with Adj. Steel Plate for 700 Euro Hinge [600.0P71.05 & 600.0932.05]**



**165 Heavy Duty Full Overlay Adjustable Soft Close Hinge with 8mm Press In Dowels. [700.0m73.05]**



**105 Standard Duty Pie Corner Hinge Adjustable Self Close Hinge with 8mm Press In Dowels. [500.0U22.75].**



### Draw Slides

**18" 20" & 22" Heavy Duty Ball Bearing Soft Close 100lbs Full Extension Draw Slide [303.FUSFT18]**



**18" & 22" Heavy Duty Under Mount Soft Close 100lbs Full Extension Draw Slide [USE58-300-21]**





**4" & 6" Height Full Ext. Soft Close  
Metal Draw System (MDB-164-450)**

**Shelve Pin Spoon Adj.  
5mm (1306BN)**



**Shelve Pin Angled  $\frac{3}{4}$ "  
5mm (1706)**



**Adjustable Feet for  
Toe Kick (TP03)**

**Leg Leveler with T-  
nut 4" x 1" (LL-120)**



## 13. Accessories/Specialty:

### **C Profile Door Handle – MC 18 (Aluminium)**



### **C Profile Door Handle – MC 18 (Black)**



## Sierra Door Profile – MC 18 (Aluminium)

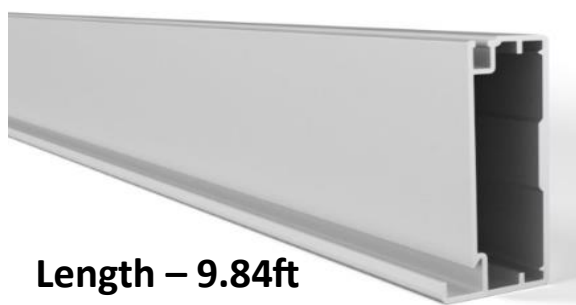

Length – 9.84ft

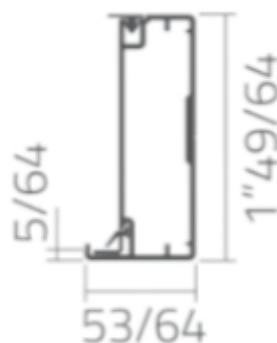

## Arming Bracket with screws (20/45)

Glass Profile is Suitable for 1/8" and 5/32" Glass Thickness.

## 14. Accessories - Specialty:

**Classis Closet Kit** - Elevate your space with our cutting-edge sliding door systems. Streamlined design meets effortless functionality, offering a modern solution for seamless room division. Upgrade your interiors with our premium Sliding Door Systems.



### CLA Kit



Length – 9.84ft



Length – 9.84ft

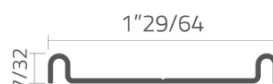

Length – 9.84ft



## Hanging Tubular Bar for closet (OVO)

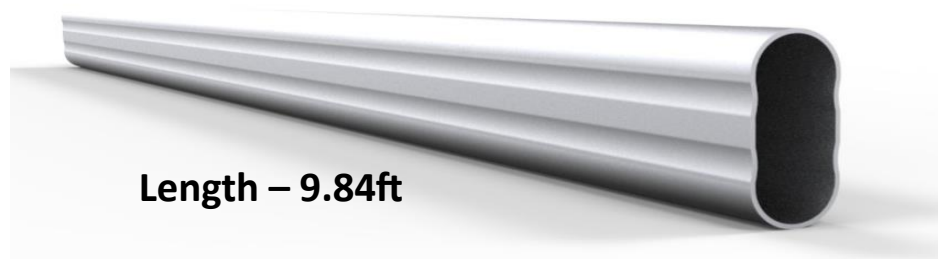

## Central Mount for OVO



## Side Mount for OVO



## "H" Profile Joint

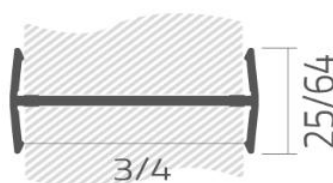
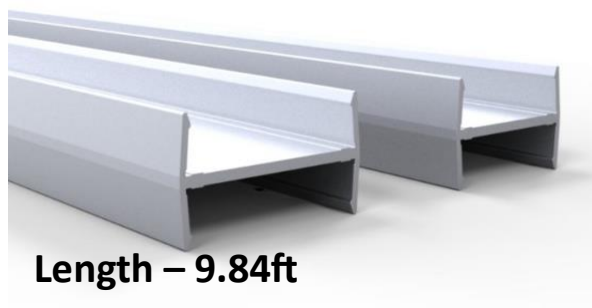

## Shelf Mount

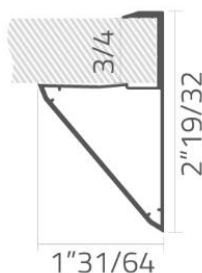

## 15. Accessories-Sinks:

1. Top Mounted – Single Sink



2. Top Mounted – Double Sink



4. Under Mounted – Double Sink



3. Under Mounted – Double Sink



➤ Design and Style vary widely, contact us and we'll help you to select your preferred design.

## 16. Countertops-Granite:

### 6. Venatino White - 104" x 57" x 2cm

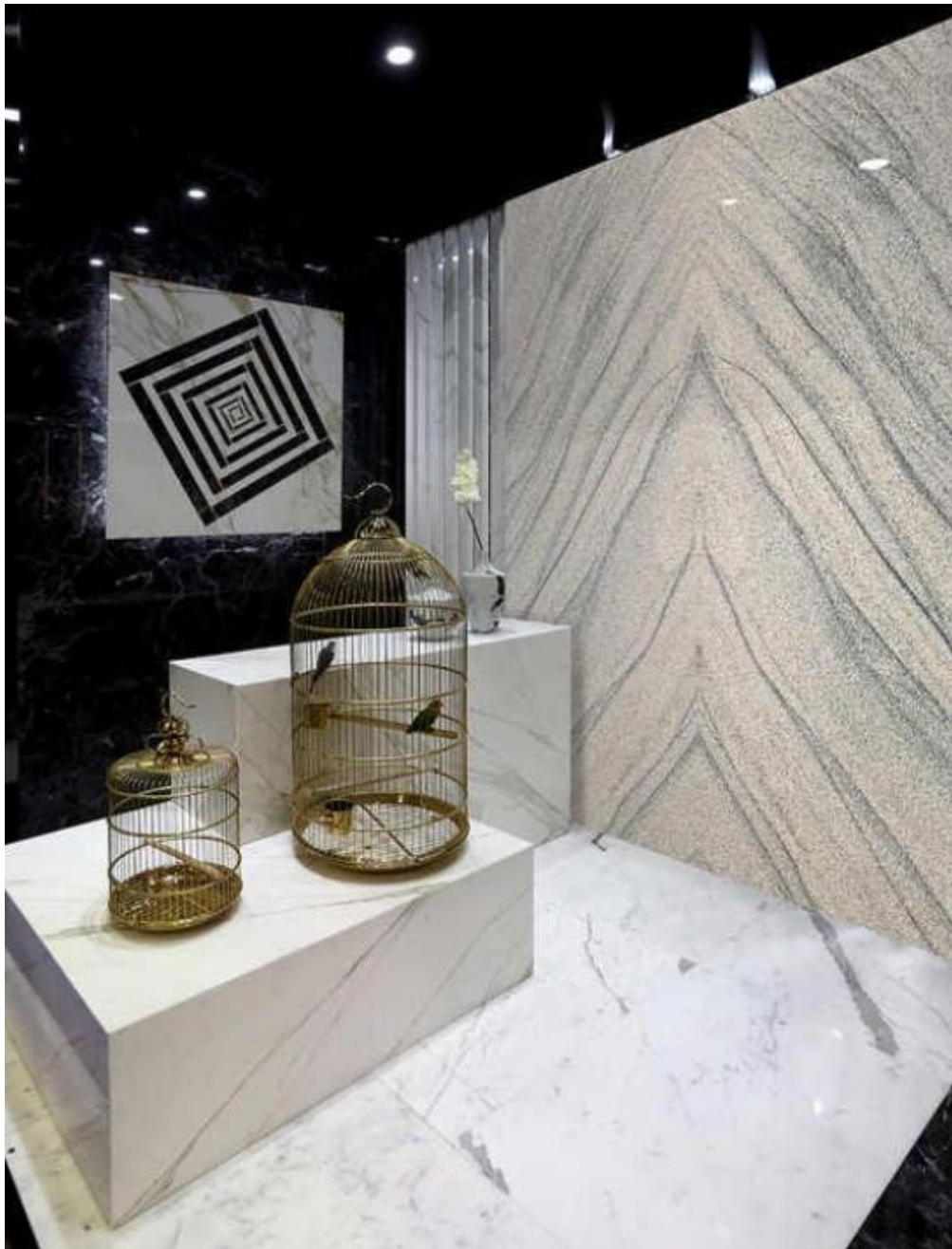



1. Rosa Minho – 118" x 69" x 2cm



2. Golden Beach - 113" x 63" x 2cm



3. Surf Black & White - 126" x 78" x 2cm



4. Brown/Tan - 119" x 66" x 2cm

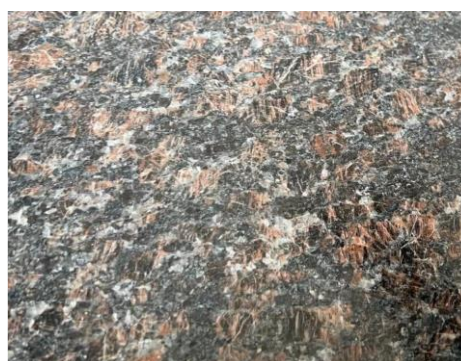

5. Black Panda - 128" x 64" x 2cm



7. Rosa Pink - 116" x 64" x 2cm



## 17. Countertops-Quartz:



1. Plain White - 127" x 64" x 1.8cm



1. Statuary Calacatta - 127" x 64" x 2cm



2. Nuvo Calacatta - 127" x 64" x 2cm



4. Gold Calacatta - 127" x 64" x 2cm



3. White & Grey (5123) - 127" x 64" x 2cm



6. Black Galaxy - 127" x 64" x 2cm

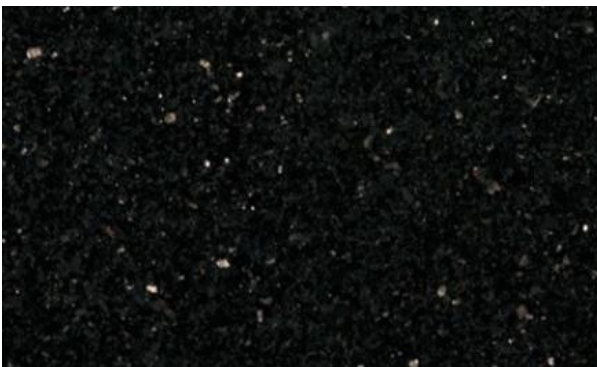

5. White Galaxy - 127" x 64" x 2cm

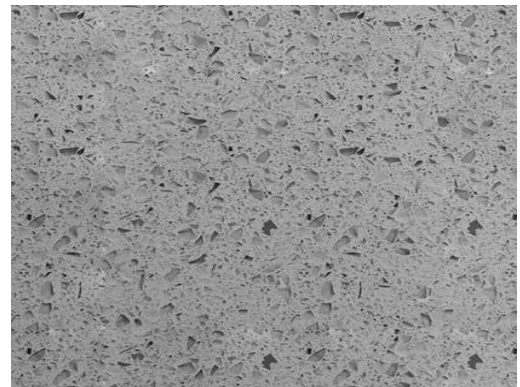

7. Grey Galaxy - 127" x 64" x 2cm



8. Grey & White - 127" x 64" x 2cm

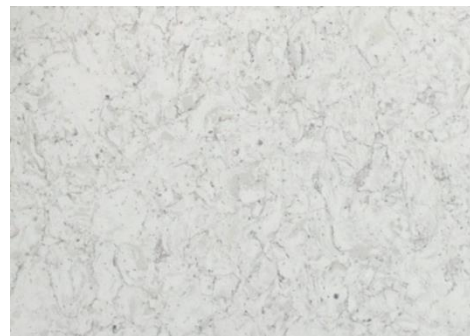

## 18. *Countertops-Laminated:*

Prefabricated White - 98" x 26" x 1.8cm

Prefabricated White - 74" x 26" x 1.8cm

Prefabricated Light Grey - 98" x 26" x 1.8cm

Prefabricated Light Grey - 74" x 26" x 1.8cm



Prefabricated Dark Grey – 98" x 26" x 1.8cm

Prefabricated Dark Grey - 74" x 26" x 1.8cm

Prefabricated Brown - 98" x 26" x 1.8cm

Prefabricated Brown - 74" x 26" x 1.8cm



## 19. Ceiling Tiles:

### Elevate Design - Ceiling Solutions



#### ➤ General Information

- Products are manufactured by **PRANCE Building Materials Co. Ltd.** Who is a leading professional manufacture of ceiling and partitions systems in China. They have won a very high reputation with more than 20 years of production experience and material development.
- They poses CE, ISO 9001:2000 and other international quality management systems certification.

TECHNICAL SPECIFICATION	
MATERIAL	Wet-formed mineral fiber
SURFACE FINISH	Factory-applied vinyl latex paint
COLOUR	White
NRC	0.5
CAC	Minimun 30
EDGE DETAIL	Angled Tegular
	Square Lay-on
LIGHT REFLECTANCE	Minimun LR0.8'
RH75 PERFORMANCE	Appropriate for relative humidity up to 75% to 95%, Temperature up to 86° F(30°C)
INSULATION VALUE	Average R Factor(at75° F,24°C) is 1.31(BTU units), 0.23(Watts units)
CERTIFICATE & STARNARD	CE En13162



## Product and Packaging Specification

<u>Item #</u>	<u>Description</u>	<u>Standard</u>
1	Design Type	Square Edge (P2) and Tegular Edge(P4)
2	Size	603 mm x 603 mm (Both P2 and P4)
3	Thickness	P2 – 15mm and P4 - 12mm
4	Sound Absorption	=/> NRC 0.55
5	Dangerous Substances	None
6	Packaging	White Carboard Carton w/ Black Text
7	Quantity per case (#)	10
8	Quantity per case (sq. Ft)	40

## Designs Available

### Square Edge

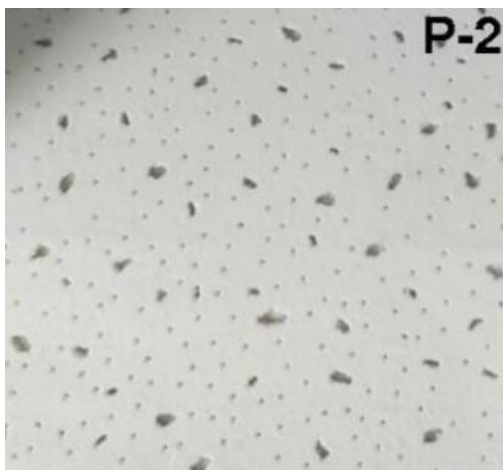

### Tegular Edge



PRODUCT CHARACTERISTIC	
 <p>fire proof performance Standard:GB8624-1997 Level:B1</p>	 <p>Rh75 to Rh95 performance</p>
 <p>Light reflectance:Minimun LR0.80</p>	 <p>Insulation:Average R Factor (at 75 degree)is 1.31(BTU units), 0.23(Watts units)</p>

## ➤ Vinyl Laminated/ PVC Gypsum Tile

### TECHNICAL SPECIFICATION

SURFACE DISPOSAL	PVC FILM IMPORTED FROM TAIWAN AND ALUMINUM FOIL FOR BACK SIDE
PERMISSIBLE TOLERANCE	LENGTH $\leq \pm 2.0\text{mm}$
	WIDTH $\leq \pm 2.0\text{mm}$
	THICKNESS $\leq \pm 0.5\text{mm}$
	DIAGONAL $\leq \pm 1.5\text{mm}$
NOISE REDUCTION COEFFICIENT	0.1-0.3
UNIT AREA QUALITY	7mm<6.5kg/m <sup>2</sup> 8mm<7.5kg/m <sup>2</sup> 9mm<8.5kg/m <sup>2</sup>
LOAD AT BREAK	7mm $\geq 110\text{N}$ 8mm $\geq 120\text{N}$ 9mm $\geq 140\text{N}$
FIREPROOF PERFORMANCE	ACCORDING WITH CHINESE STANDARD GB624-1997
CERTIFICATE & STARNARD	CE En13964



tem #	Description	Standard
1	Design Type	Square Edge – 103, 154, 569
2	Size	595 mm x 595mm
3	Thickness	7mm
4	Sound Absorption	=/> NRC 0.1-0.3
5	Dangerous Substances	None
6	Packaging	White Carboard Carton w/ Black Text
7	Quantity per case (#)	10
8	Quantity per case (sq. Ft)	40

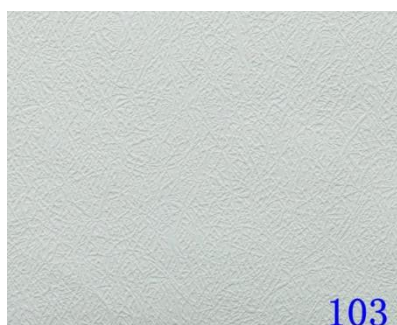

103

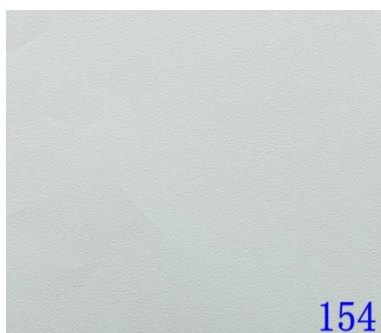

154

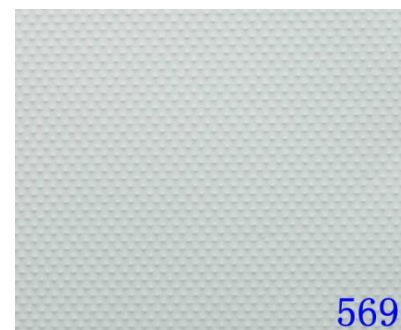

569

## Installation Method

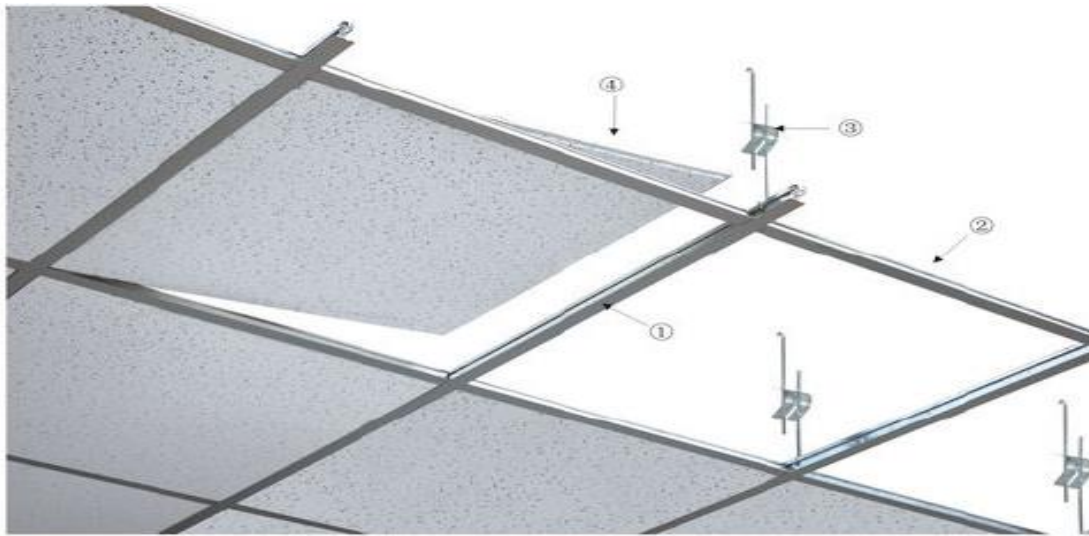

① Main tee    ② Cross tee    ③ Hanger for T-grid    ④ Mineral fiber tile

## Grid System

**Wall Angle – Length 10'/3000mm**

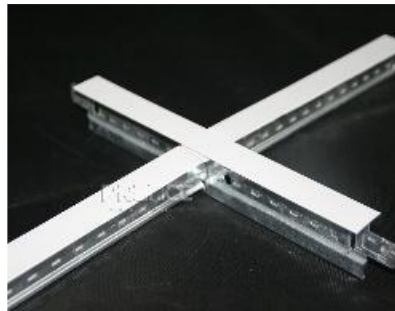
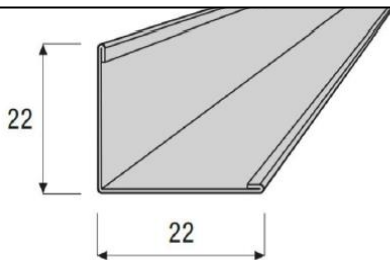

**Cross Tee – 2ft/610mm**

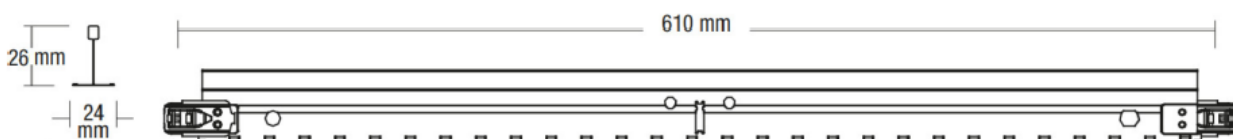

**Cross Tee – 4ft/1220mm**

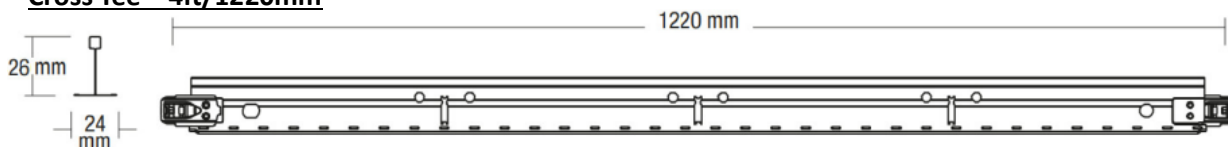

**Main Tee – 12ft/3660mm**

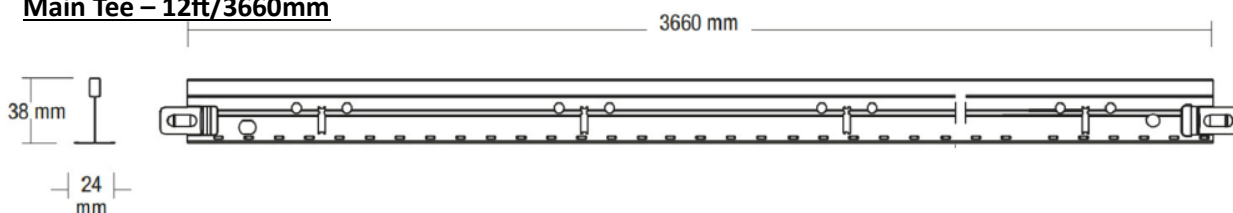

**Thank You**

*for making it*  
Elevate Business Services



## Contact Us

📞 Office: 1-876-648-7371    ✉️ Info@elevateja.com

📞 Cell: 1-876-494-1224

📍 Unit #7, Lot 10 Twickenham Park, Industrial Estate,  
St. Catherine, Jamaica.

## Office Hours

Monday - Friday    **8:30 am - 5:30 pm**

Saturday    **Appointments Only**

Sunday    **Closed**